

SMT Power Inductor

SILM4015 Type

Features

- RoHS compliant.
- Low profile(1.5mm max.height)SMD type.
- Magnetically shielded, suitable for high density mounting.
- Self-leads ,suitable for high density mounting.
- High energy storage and low DCR.
- Provided with embossed carrier tape packing.
- Ideal for power source circuits, DC-DC converter, DC-AC inverters inductor applications.
- In addition to the standard versions shown here, customized inductors are available to meet your exact requirements.

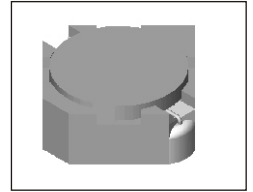

Mechanical Dimension :

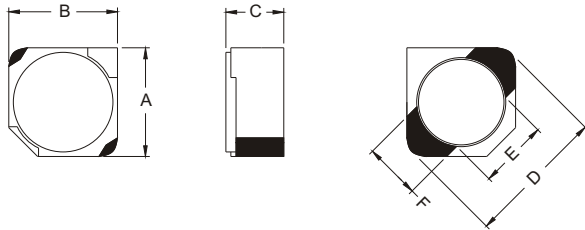

RECOMMENDED PAD PATTERNS

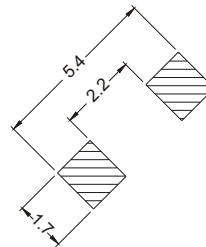

UNIT:mm/inch
 A = 4.0 / 0.157 Max.
 B = 4.0 / 0.157 Max.
 C = 1.5 / 0.059 Max.
 D = 4.8 / 0.189 Max.
 E = 2.9 / 0.114
 F = 1.0 / 0.039

Electrical Characteristics : 25°C : 100KHz, 0.1V

PART NO.	L ¹ (uH)	DCR (mΩ) MAX	I _{rated} ² (A dc)
SILM4015 - 1R0	1.0	69	2.00
SILM4015 - 1R5	1.5	84	1.70
SILM4015 - 2R2	2.2	98	1.40
SILM4015 - 2R7	2.7	114	1.30
SILM4015 - 3R3	3.3	126	1.00
SILM4015 - 3R9	3.9	144	0.90
SILM4015 - 4R7	4.7	180	0.88
SILM4015 - 5R6	5.6	198	0.85
SILM4015 - 6R8	6.8	264	0.80
SILM4015 - 8R2	8.2	288	0.75
SILM4015 - 100	10.0	306	0.50
SILM4015 - 120	12.0	366	0.45
SILM4015 - 150	15.0	462	0.42
SILM4015 - 180	18.0	510	0.40
SILM4015 - 220	22.0	732	0.37
SILM4015 - 270	27.0	840	0.33
SILM4015 - 330	33.0	1104	0.31
SILM4015 - 390	39.0	1182	0.28
SILM4015 - 470	47.0	1356	0.25

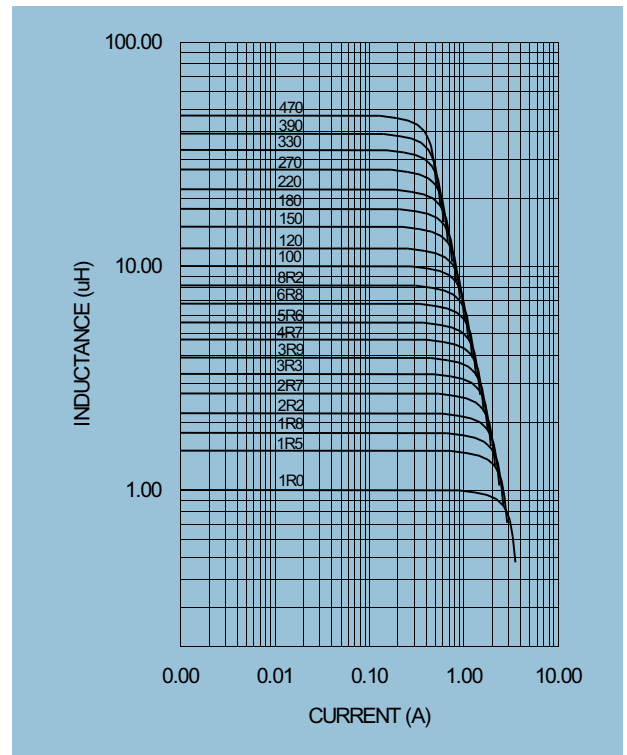

1. Tolerance of inductance : ± 30% for 1.0~8.2uH, ± 20% for 10~47uH.
2. I_{rated} is the DC current which cause the inductance drop 35% typical of its nominal inductance without current and the surface temperature of the part increase less than 45°C.
3. Operating temperature: -20°C to 105°C (including self-temperature rise).



DELTA ELECTRONICS, INC.

(TAOYUAN PLANT CPBG) 252, SAN YING ROAD, KUEISAN INDUSTRIAL ZONE, TAOYUAN SHIEN, 333, TAIWAN, R.O.C.

TEL: 886-3-3591968; FAX: 886-3-3591991

<http://www.deltawww.com>

Free Manuals Download Website

<http://myh66.com>

<http://usermanuals.us>

<http://www.somanuals.com>

<http://www.4manuals.cc>

<http://www.manual-lib.com>

<http://www.404manual.com>

<http://www.luxmanual.com>

<http://aubethermostatmanual.com>

Golf course search by state

<http://golfingnear.com>

Email search by domain

<http://emailbydomain.com>

Auto manuals search

<http://auto.somanuals.com>

TV manuals search

<http://tv.somanuals.com>